

Wing Bents with Dormers

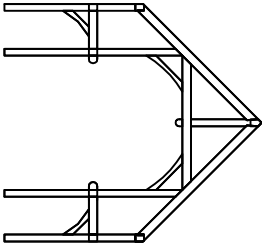

Bents 1 and 3

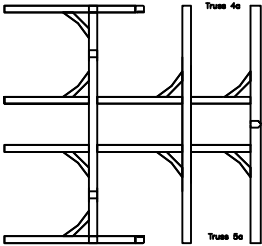

Bent 2

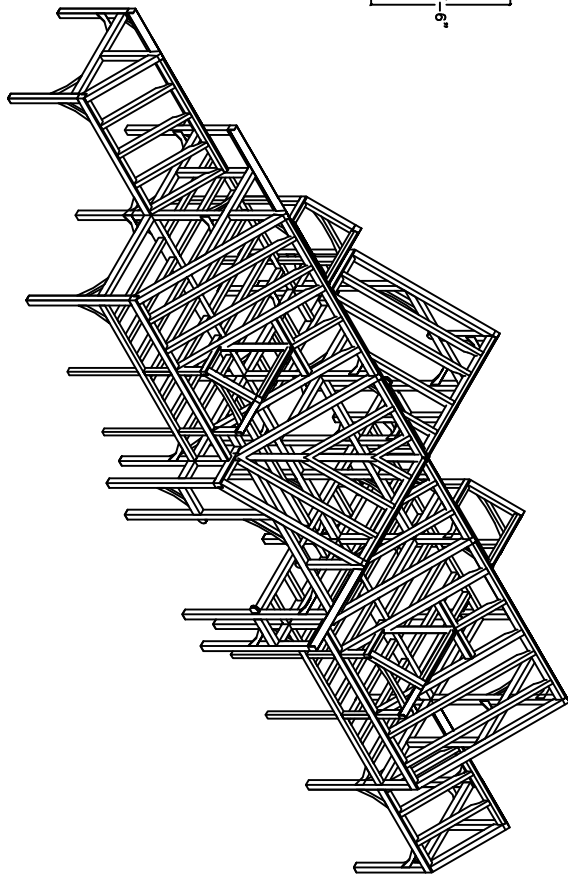

Standing Rock
 Frame Style: Large Plus Shaped Cape with Bumpouts
 Additions: Greatroom with catwalks and loft,
 four timberframed dormers, six valley systems,
 and two timberframed bumpouts
 First: 2277
 Second: 1484
 Total Timberframe: 3761

Wind River Timberframes

14374 County Road 35.6 * Mancos, Colorado 81328 * (970) 882-2112